

Global Premier-Slide

The Premier-Slide combines robust engineering and hi-tech electronics to create a heavy duty sliding operator. The Premier-Slide is a surface mounted, electro-mechanical sliding door operator suitable for all applications.

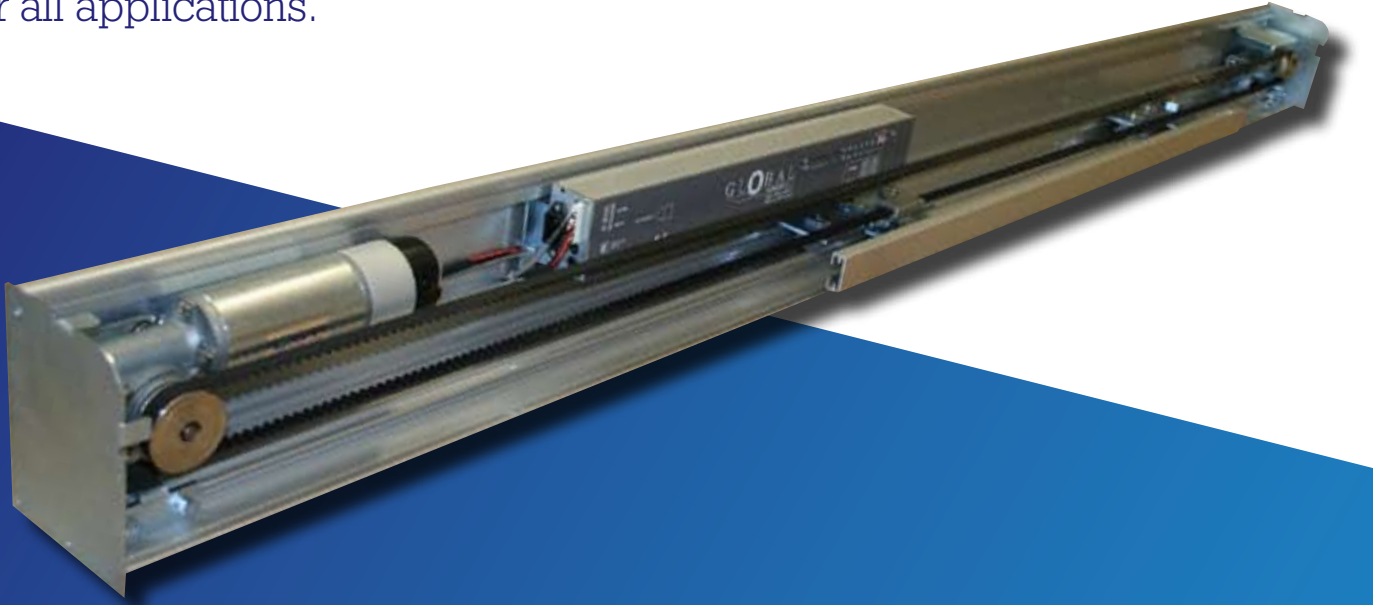

Key Features

- Design allows for easy installations, repairs and maintenance
- A micro-processor driven system and heavy duty motor gearbox, control our smoothest ever automatic door
- An aluminium sliding door track only 13cm allow this to be one of the most versatile automatic sliding door systems

Safety Functions

- Safety sensors in the opening of the door prevent the door from shutting if persons or objects are in the detection zone
- Auto-reversing: if the door leaves are inhibited when closing, they are immediately re-opened. If the door leaves are hindered when opening, they are immediately stopped. The position of the obstacle is stored and will be slowly approached during the next door movement
- In case of an emergency the door system will open and stay in that position to aid escape through the widest possible opening
- Sidescreen protection – sensors installed above the side screens where the door slides, protect against the leaves striking an object

Emergency Panic

- Electronic monitored “smart” System - Fail to open device
- Stop functions and Full “Breakout” options are available

Finishes

- Our sliding operator is available in anodised aluminium and a wide range of powdercoated colours

Operating modes

- Automatic mode with full opening width
- Automatic mode with reduced opening width (Winter opening)
- One-way (Exit only) for traffic control
- One-way (Enter only) for traffic control
- Hold Open; either full open or reduced opening width
- Off mode:



All-in-one control allows for a quick installation



Technical Specification

Motor Gearbox

Heavy duty 90w motor gearbox with a steel shaft and pulley. Micro processor controlled positioning encoder and an integrated magnetic motor lock.

Control Unit

The control unit is fully microprocessor controlled and has an integrated switched mode power supply (SMPS). It has a built-in control fuse rated at 3A 250V. All connections for external components are connected to the control unit via different connectors and a dedicated connection board.

Emergency Battery Backup

An integral, monitored battery system will open the door to its full position and hold it there in the event of a power failure. (Fire alarm input does the same thing)

Drive System

All the drive brackets are manufactured from heavy steel. The drive is provided via a reinforced toothed drive belt, running between the motor gearbox and an idler pulley.

Wheels & Anti riser:

The Premier-Slide utilises nylon wheels and anti risers on and aluminium track for the quietest possible operation

Track and Canopy:

An extruded aluminium track and canopy with reinforced running area. The track and canopy hinges for easy access to the equipment. Canopies are supplied in mill for polyester powder coating or Silver anodised to AA25 Standard.

Sliding Door - Double Set Tunnel Fix

Clear Opening = Structural Opening - 300mm
Door Leaves Closed

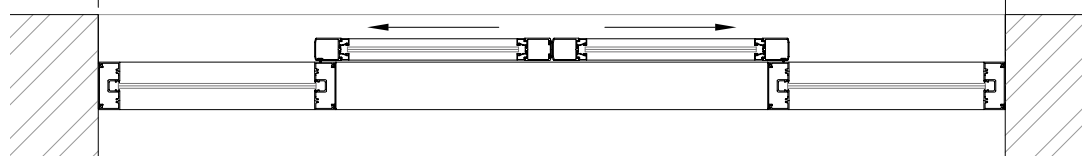

Based on a 100mm x 45mm frame

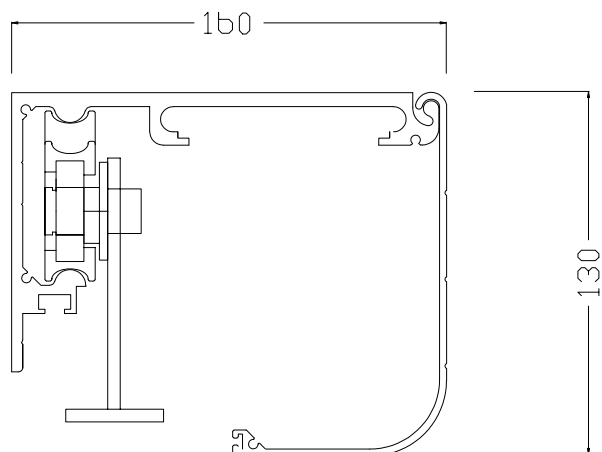
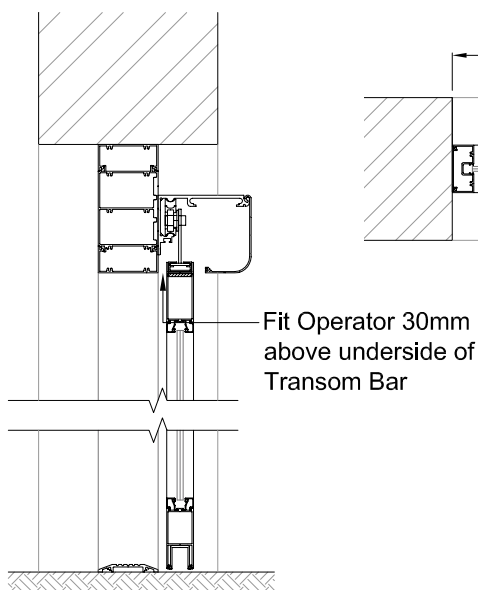

	Single door	Double door
Max Door Width	2000mm	3000mm
Max Door Height	2500mm	2500mm
Max Door Weight	100kgs	160kgs
Mains Voltage	80v – 250V ac	
Power Consumption	Standby: Max 10W / Hour Operating Mode: Max 150W / Hour	
Hold Open time	1 – 10 Sec	
Opening Speed	Max 600mm / Sec	
Closing Speed	Max 400mm / Sec	
Reduced Opening	70% Of Opening Width (Fixed)	
Aux Power Supply	24V dc 2 amp	
Ambient Temperature	- 20° to +55°	