

AUTOMATIC DOOR SAFETY SENSOR



Ultrasonic Presence Detection Safety Sensor

Coverage Patterns

Three different types of detection pattern are available.
Bird Eye View

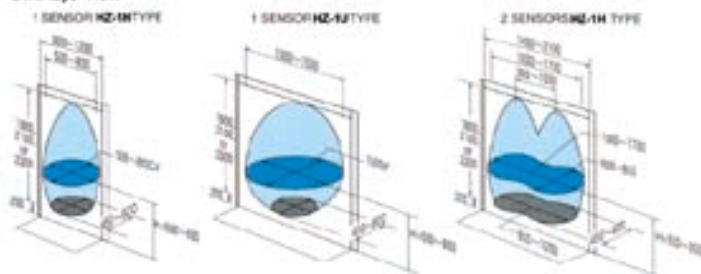

Sensor Assembly & Install Height

1. Assembly 1:1

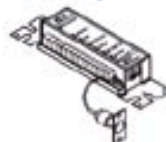

Installed height	2.0~2.5m	2.5~3.0m
SW Height	2.5m	3.0m
Sensor	2-Side Door HZ-1U HZ-1R	1-Side Door HZ-1H HZ-1H

2. Assembly 1:2

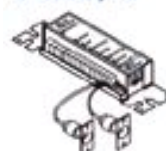

Installed height	2.0~2.5m	
SW Height	3m	
Sensor	2-Side Door HZ-1U HZ-1R	1-Side Door HZ-1H

Caution
When two sensors are used SW height should be 3m. In case of using 2 sensors and height of 2.5m or more, please be consulted.

Adjustable Area & Range

Range Adjustment

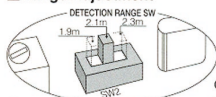

Open the cover to turn internal SW2 to 1.9m, 2.1m or 2.3m as required. (2.1m is factory set)

Manual SW2	1.9m	2.1m	2.3m
Mounting Height 2.0m~2.1m Sensor Heads HZ-1H Undetectable range off the floor	2.0m~2.1m 0.1m floor 0.2m	2.2m~2.3m 0.1m floor 0.2m	2.4m~2.5m 0.1m floor 0.2m
Mounting Height 2.0m~2.1m Sensor Heads HZ-1U Undetectable range off the floor	2.0m~2.1m 0.1m floor 0.2m	2.2m~2.3m 0.1m floor 0.2m	2.4m~2.5m 0.1m floor 0.2m

Outer Dimensions (mm)

Controller

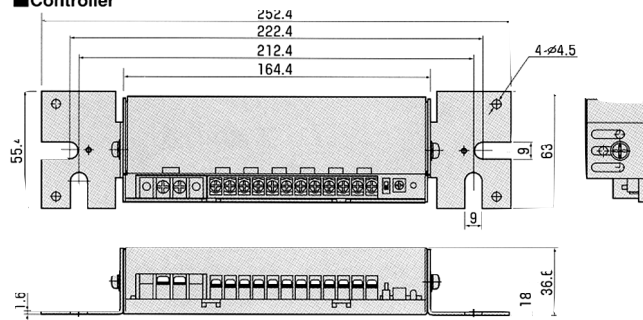

Initial Learn Switch

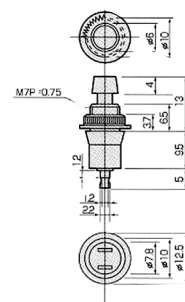

Sensor Head HZ-1H

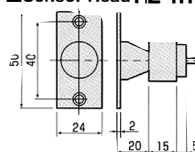

Sensor Head HZ-1U

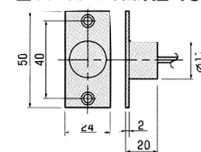

Model	HZC-CS-BC (Constant Sensing)
Detection Method	Presence Detection by Ultrasonic Reflection Detection
Power Supply	AC/DC 24C ± 10% 50/60 Mhz
Power Consumption	1.8VA - 24V AC, 70mA-24V DC
Output Contact	Relay Type 1a: Normally Close With Fail Safe Max Rating (Resistance Load) 1A-24V DC/24W, 0.5A-120V AC/60VA
Response Time	0.15 Sec. Max
Led Indication	Power On: Red Led On, Operating: Red Led Off
Sensor Installation Height	2 to 3 M (1.3 To 6.5 Ft)
Detection Area Height	0.4 to 2 M (1.3 To 6.5 Ft)
Temperature Range	-10°C to +40°C
Weight	550 G

NOTE:
Specifications may change without prior notice



HOTRON IRELAND LTD.

37 Dublin Street (2nd Floor), Carlow, Ireland.
Tel: +353-(0)503-40345 · Fax: +353-(0)503-40543
URL: <http://www.hotron.com>

HOTRON CO. LTD.

1-11-26 Hyakunin-cho Shinjuku-ku, Tokyo 169-0073, Japan.
Tel: +81-3-5330-9221 · Fax: +81-3-5330-9222
URL: <http://www.hotron.co.jp>